



QUICK REFERENCE GUIDE

Eventide®

H90

Harmonizer®



Scan the code to read the
H90 user manual.

Register your H90 at:
eventideaudio.com/my-account

H90 Harmonizer Quick Reference Guide for Firmware v1.0+
Eventide Part# 141360 Rev A

Bluetooth® and the Bluetooth logo are registered trademarks of Bluetooth SIG, Inc.

Eventide is a registered trademark of Eventide Inc.

Harmonizer is Eventide's trademark for a special effects device incorporating pitch change.

© 2022 Eventide Inc. All rights reserved.

Overview

Select Knob

Press to enter Select/Bank Mode.

Edit Mode Buttons

Press to enter Edit Modes.
(See table on right)

Quick Knobs

Adjust parameters and settings.

Footswitch LED Buttons

Play Modes: Color indicates footswitch function.

Edit Modes: Program and Presets active/bypass status.

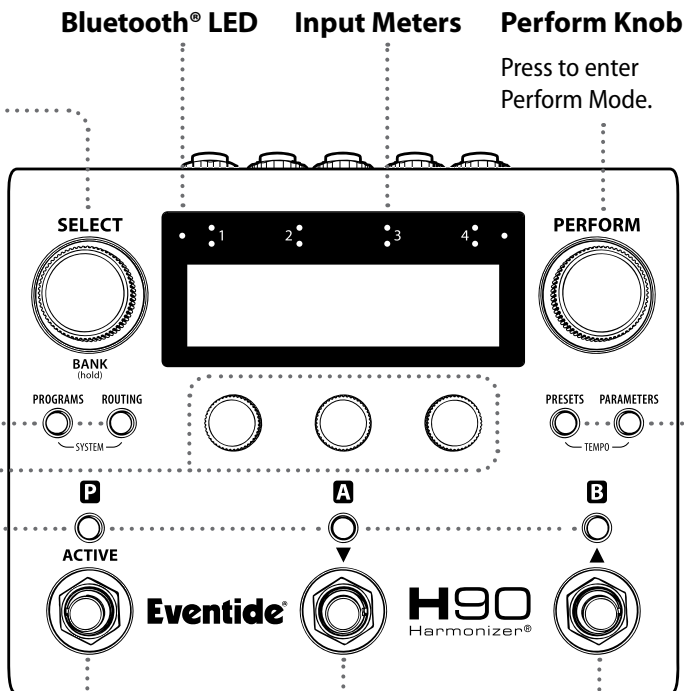

Bluetooth® LED
Input Meters
Perform Knob
Press to enter Perform Mode.

Footswitches
Select/Bank Mode: Scroll through and load Programs.
Perform Mode: User-programmable footswitches.

Play Modes

Select / Bank

Cue and load from the Playlist. (pp. 4–5)

Perform

Customize footswitches for live performance. (p. 6)

Edit Modes

Programs

Browse Programs by List, Effect Type and Algorithm. (p. 7)

Routing

Configure Preset Routing and position external Inserts. (pp. 8–9)

Presets

Browse User/Factory Preset Library by Effect Type and Algorithm. (p. 10)

Parameters

Edit Program and Preset parameters. (p. 11)

Anatomy of a Program

Program P

Active/Bypass, In/Out Gain, Routing & Inserts
Exp/Ctl mappings, HotKnob, HotSwitch (x3)

Preset A

Active/Bypass, In/Out Gain, Algorithm & settings, HotKnob

Preset B

Active/Bypass, In/Out Gain, Algorithm & settings, HotKnob

I/O

Inputs 1/2

Main mono or stereo Inputs.

Outputs 1/2

Main mono or stereo Outputs.

Exp/Ctl 1/2

Inputs for expression pedals or aux switches.

Power

Power requirement is 9–12VDC, 12W, center positive (+), 5.5mm/2.5mm jack.

Line Lvl Indicators

LED grid indicates which Inputs or Outputs are set for line level signals.

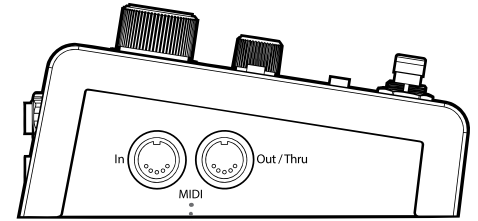
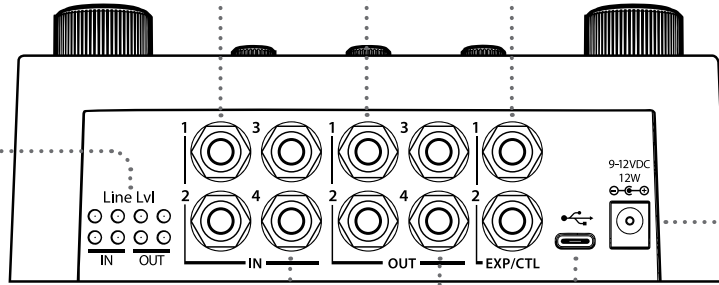

Inputs 3/4

External Insert return, or Input for Dual Path 2.

Outputs 3/4

External Insert send, or Output for Dual Path 2.

USB-C

Connect to your computer for control, updates and MIDI.

MIDI In and Out/Thru

Receive, transmit and pass through MIDI program changes, control changes and clock.

INSERT ROUTING

● Main Path ● Send ● Return

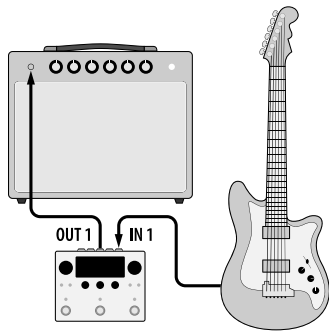

Simple Effects Pedal Setup

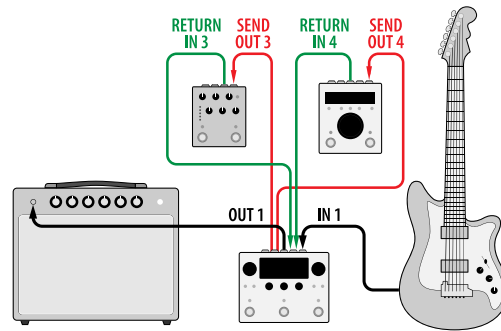

Two Mono Inserts

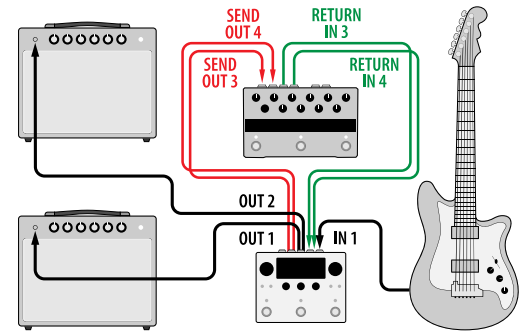

One Stereo Insert

Global I/O Configuration

IN	I/O	Insert (Default)	Dual
① ③	IN 1	Main Input Left (Mono)	Path 1 Input Left (Mono)
② ④	IN 2	Main Input Right	Path 1 Input Right
	IN 3	Insert 1 Return	Path 2 Input Left (Mono)
	IN 4	Insert 2 Return	Path 2 Input Right
	OUT 1	Main Output Left (Mono)	Path 1 Output Left (Mono)
	OUT 2	Main Output Right	Path 1 Output Right
① ③	OUT 3	Insert 1 Send	Path 2 Output Left (Mono)
② ④	OUT 4	Insert 2 Send	Path 2 Output Right

Insert Routing in Series (p. 8)

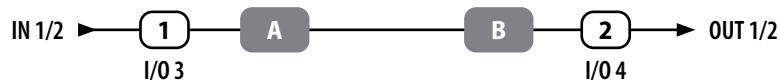

Dual Routing in Pre/Post (p. 9)

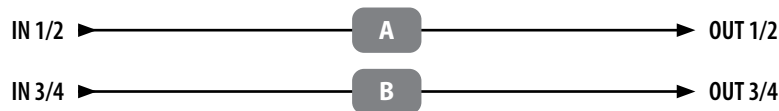

NOTE: When using H90 with four cable method or pre/post in an amp effects loop, Dual Routing is strongly recommend.

Insert Routing is enabled by default. Global Routing can be switched between Insert and Dual in Global settings on the System Menu (see p. 12). H90 has a complete set of alternate Program Lists with Dual Routing.

DUAL ROUTING

● Path 1 ● Path 2

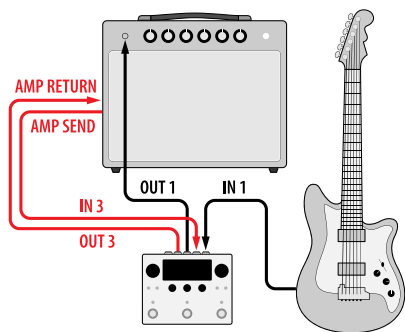

Amplifier Pre/Post (Mono)

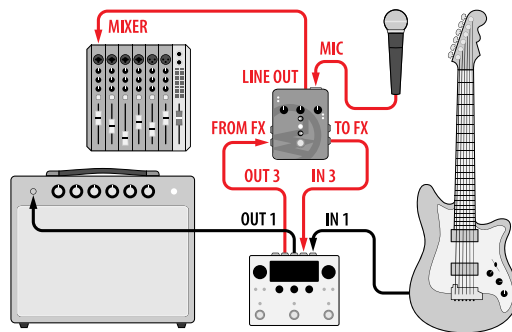

Guitar and Vocals (with MixingLink®)

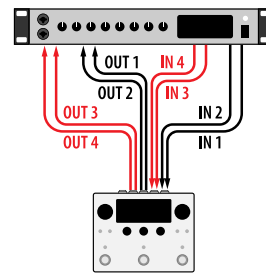

Dual Inserts into DAW

Select

Select Knob

Turn to scroll through the Playlist, and cue up a Program.

Press to load a cued Program.

Press and hold to toggle Bank Mode.

Quick Knobs

Turn to adjust parameter value.

Press to view parameter values.

Press again to toggle pages.

Press and hold to enter parameter assignment page.

Footswitch LED Buttons

FS1 LED: Press to Active/Bypass **P**.

FS2 or 3 LED: Press to momentarily display the corresponding Preset name.

Press again to Active/Bypass Presets **A**, or **B**.

Perform Knob

Turn to adjust HotKnob **P** value.

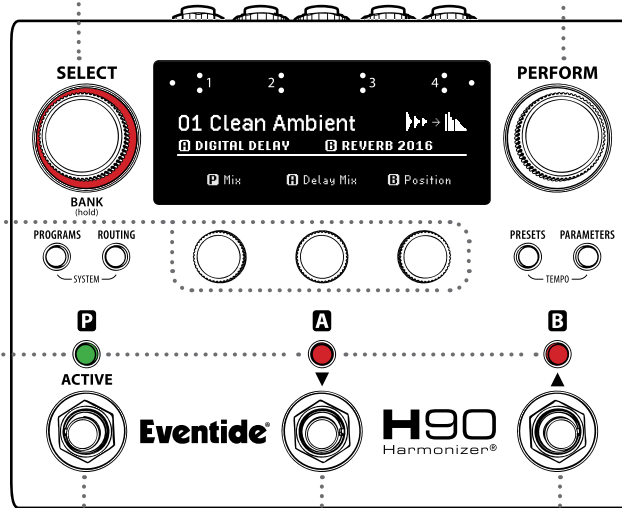

Footswitch 1

Press to activate a cued Program.

Press to Active/Bypass the loaded Program.

Footswitch 2 ▼

Press to scroll down through the Playlist.

Footswitch 3 ▲

Press to scroll up through the Playlist.

The Playlist

The Playlist is the currently enabled User Program List for Select/Bank Modes. The H90 can have many Program Lists, but only one User List is designated as THE Playlist. Factory Lists found in Programs Mode cannot be used as the Playlist. The Playlist is selected in System Menu (See p. 12).

Program number and name Effect Type symbols



A and **B** Algorithm and Preset names



Series Routing



Parallel Routing



Six assignable parameters per Program (two pages). Press and hold a Quick Knob to assign parameters.

Bank

Select Knob

Turn to scroll through the Playlist, and cue up a Program.

Press to load a cued Program.

Press and hold to toggle back to Select Mode.

Quick Knobs

Turn to adjust parameter value.

Press to view parameter values.

Press again to toggle parameter pages.

Press and hold to enter parameter assignment page.

Footswitch LED Buttons

Press to cue up a Program in the current Bank, and momentarily display the corresponding Program information.

Perform Knob

Turn to adjust HotKnob **P** value.

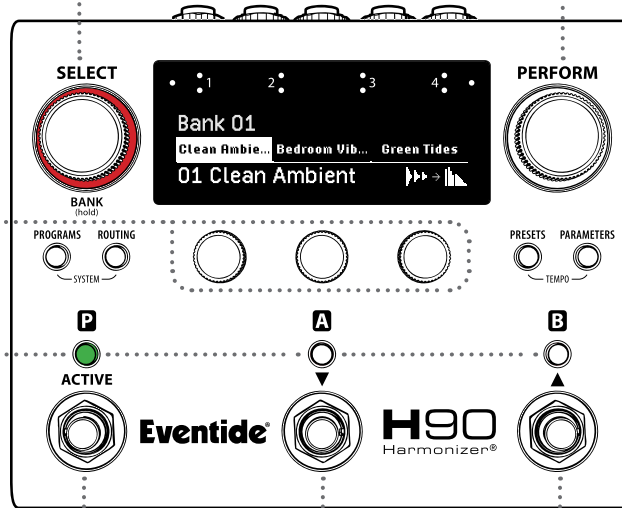

Footswitch 1

Press to load 1st Program in Bank.

Press again to Active/Bypass.

Press and hold to go to Bank 1.

Footswitch 2 ▼

Press to load 2nd Program in Bank.

Press again to Active/Bypass.

Press and hold to scroll down to previous Bank.

Footswitch 3 ▲

Press to load 3rd Program in Bank.

Press again to Active/Bypass.

Press and hold to scroll up to next Bank.

Banks

Each Playlist has 33 Banks, and each Bank displays three Programs in one view. Bank Mode can be used in live performance to quickly load a set of Programs.

Bank name (editable in H90 Control only)



Six assignable parameters per Program (two pages).



The three Programs in the current Bank.



Program 3 Active in Bank 1.

Perform

Select Knob

Turn to toggle pages of user-programmable footswitches.

Quick Knobs

Turn to adjust parameter value.

Press to view parameter values.
Press again to toggle parameter pages.

Press and hold to enter parameter assignment page.

Footswitch LED Buttons

Press to change Footswitch assignment.

Press and hold to map **P**, **A**, or **B** performance parameters to an external footswitch.

Perform Knob

Press to toggle pages of user-programmable footswitches.

Turn to adjust HotKnob **P** value.

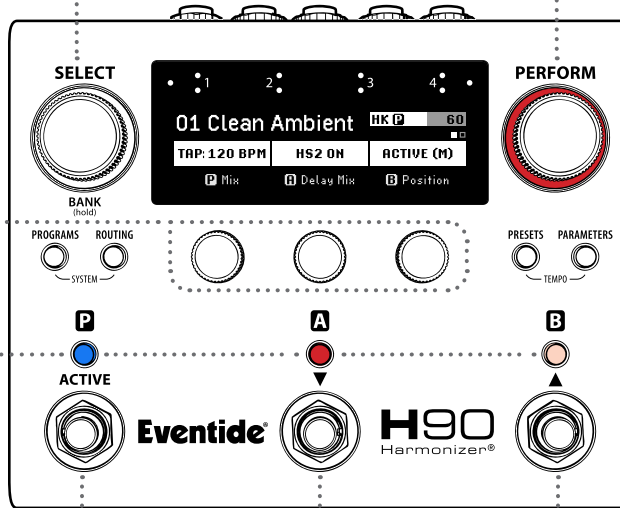

Footswitch 1

Press to engage **P** performance parameters.

Footswitch 2

Press to engage **A** performance parameters.

Footswitch 3

Press to engage **B** performance parameters.

Performance Parameters

Perform Mode features two pages of user-programmable Footswitch assignments such as tap tempo, Active/Bypass, momentary Active, three independent HotSwitches, and Algorithm-specific parameters.

Program number and name HotKnob **P**



Page 1



Page 2



Six user-programmable Footswitch assignments per Program (two pages).

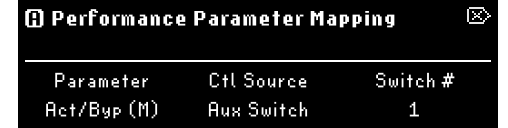

Press and hold a Footswitch LED Button to map performance parameters to an external footswitch.

Programs

Select Knob

Turn to auto-load a new Program from a filtered List.

Programs Button

Press and hold in any Mode to save the current Program.

Quick Knobs

Turn to adjust Program List search filters.

QK1: User and Factory Lists

QK2: Effect Type

QK3: Algorithm

Footswitch LED Buttons

Press to Active/Bypass **P**, **A**, or **B**.

Perform Knob

Turn to auto-load a new Program from a filtered List.

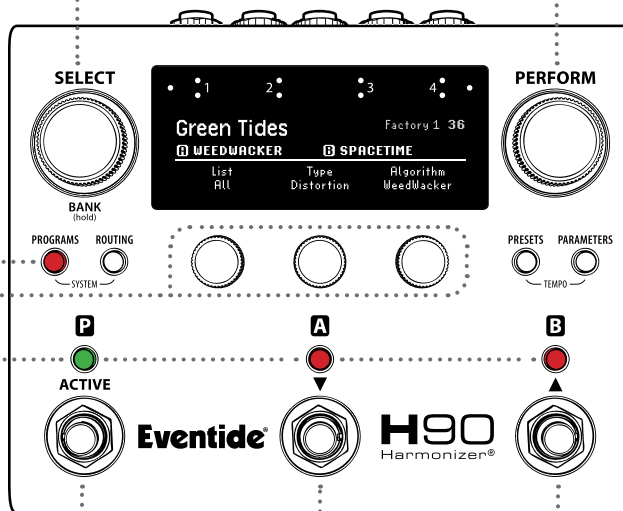

Footswitches

Press any Footswitch to exit Programs Mode.

Program Lists

H90 stores User and Factory Lists, with each List containing up to 99 Programs. In Programs Mode all Lists can be searched based on Effect Type and Algorithm. The Playlist can be changed in Global settings on the System Menu (see p. 12).

Filtered Program name Location and number

Green Tides	Factory 1 36
A WEEDWACKER	B SPACETIME
List All	Algorithm WeedWacker
Type Distortion	

Browse Programs by List, Effect Type and Algorithm.

Cancel	Save Program →
03 Green Tides	User 1

Press and hold PROGRAMS Button to enter Program saving, select a destination List and number.

← Back	Save Program
03 Green Tides	<Delete>
Cursor	ABC

Turn SELECT Knob to move cursor, turn PERFORM Knob to change character, press PERFORM Knob to save.

Insert Routing

Select Knob

Turn to scroll through all Routing pages.

Routing Button

Press to cycle through Routing and Insert pages.

Quick Knobs

QK1: Turn to change Routing between Series and Parallel.

Press to Swap Presets **A** and **B**.

QK2: Turn to enable Insert 1 and adjust the insert position.

Press to Active/Bypass Insert 1.

QK3: Turn to enable Insert 2 and adjust the insert position.

Press to Active/Bypass Insert 2.

*Turning Quick Knob 3 all the way clockwise will enable Stereo Insert 1-2

Footswitch LED Buttons

Press to Active/Bypass **P**, **A**, or **B**.

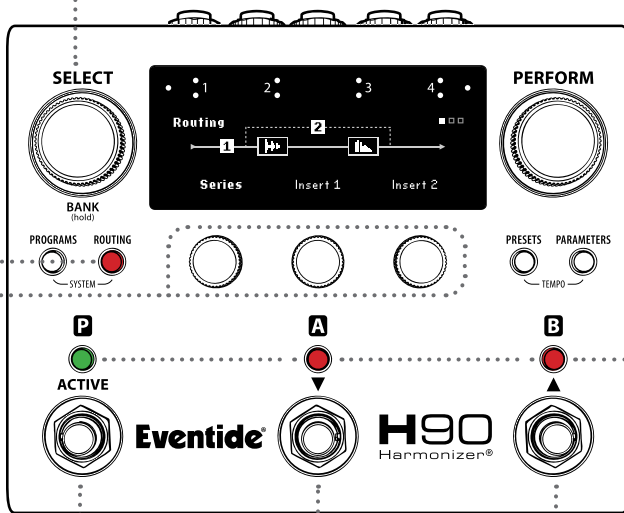

Footswitches

Press any Footswitch to exit Routing Mode.

Insert Positions

Series Routing

Pre A
Parallel
Mid
Post B
Stereo Inserts*

Parallel Routing

Pre
Pre A
Pre B
Parallel
Post A
Post B
Post
Stereo Insert*



Insert 1 (Pre A), Insert 2 (Post B) in Parallel Routing.



Insert 1 parameters, page 1.

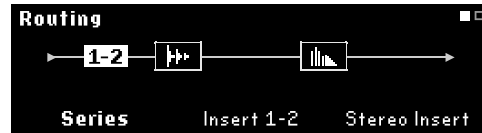

Stereo Insert: Turn QK3 all the way to the right to enable Stereo Insert. Turn QK2 to change position.

Dual Routing

Dual Routing enables two independent stereo signal paths and utilizes an alternate set of Program Lists.

Path 1: Inputs and Outputs 1/2
Path 2: Inputs and Outputs 3/4

Quick Knob 1

Turn to change Routing position for Presets **A** and **B** on Paths 1 and 2. (See table)
 Press to Swap Presets **A** and **B**.

NOTE: When using H90 with four cable method or pre/post in an amp FX loop, Dual Routing is strongly recommend.

Footswitch LED Buttons

Press to Active/Bypass **P**, **A**, or **B**.

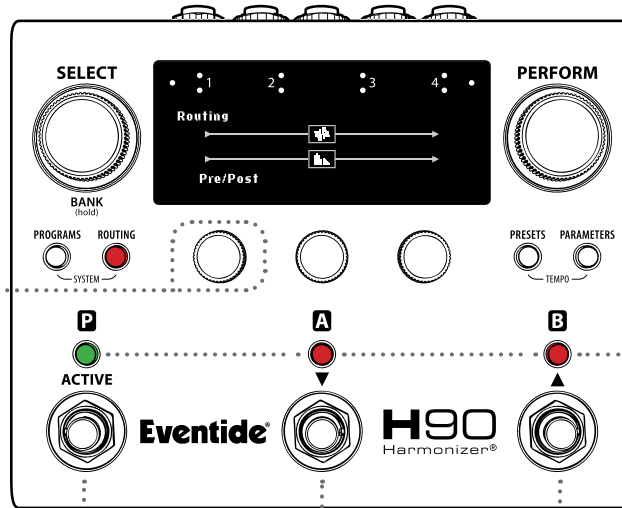

Footswitches

Press any Footswitch to exit Routing Mode.

Dual Positions		
Routing	Path 1	Path 2
Path 1 Series	Series	Thru
Path 1 Parallel	Parallel	Thru
Pre/Post	Presets A	Presets B
Path 2 Parallel	Thru	Parallel
Path 2 Series	Thru	Series

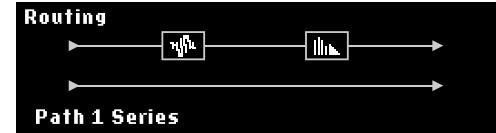

Presets **A** and **B** in Series on Path 1.

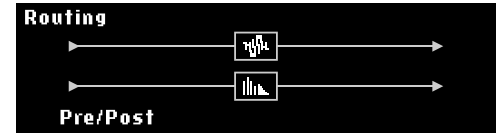

Presets **A** on Path 1, Presets **B** on Path 2.



Dual Routing in Select Mode.

Presets

Select Knob

Turn to auto-load a new Preset from the filtered search into the selected **A** or **B** slot.

Quick Knobs

Turn to adjust Preset library search filters.

QK1: Preset Library

QK2: Effect Type

QK3: Algorithm

Footswitch LED Buttons

FS1 LED: Press to Active/Bypass Program.

FS2 LED: Press to select **A**.
Press again to Active/Bypass **A**.

FS3 LED: Press to select **B**.
Press again to Active/Bypass **B**.

Perform Knob

Turn to auto-load a new Preset from the filtered search into the selected **A** or **B** slot.

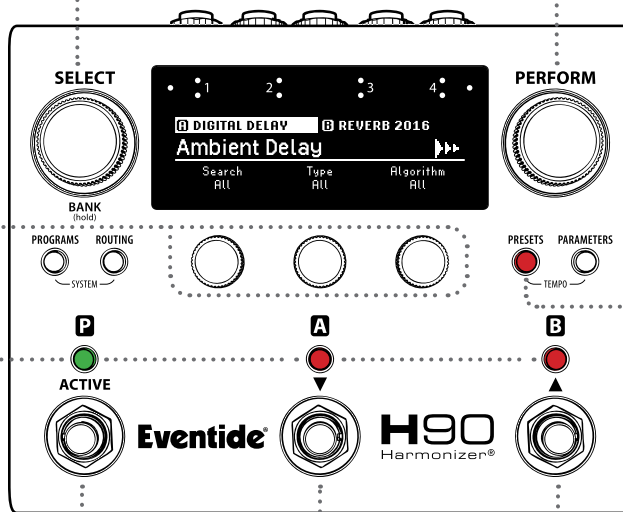

Footswitches

Press any Footswitch to exit Presets Mode.

Presets

Presets are the building blocks of a Program. Uniquely named Presets can be saved to and recalled from the Library for safe-keeping.

Algorithm **A**

Algorithm **B**



Browse Preset Library by Effect Type and Algorithm.



Highlighted Algorithm's Preset name



Preset Saving: Press and hold the PRESETS button to rename or save the selected Preset.

Presets Button

Press to toggle between Presets **A** and **B**.
Press and hold to save the selected Preset.

Parameters

Select Knob

Turn to scroll through pages of selected **P**, **A** or **B** parameters.

Quick Knobs

Turn to adjust parameter value.

Press and hold to map the corresponding parameter to HotKnob, expression pedal or external controller.

Footswitch LED Buttons

Press to select **P**, **A**, or **B** parameters.

Press again to Active/Bypass.

Press and hold to map **P**, **A**, or **B** parameters to HotSwitch 1, 2 or 3.

Perform Knob

Turn to adjust selected **P**, **A** or **B** HotKnob value.

Press and hold to map HotKnob.

Parameters Button

Press to cycle through **P**, **A** or **B** parameter groups.

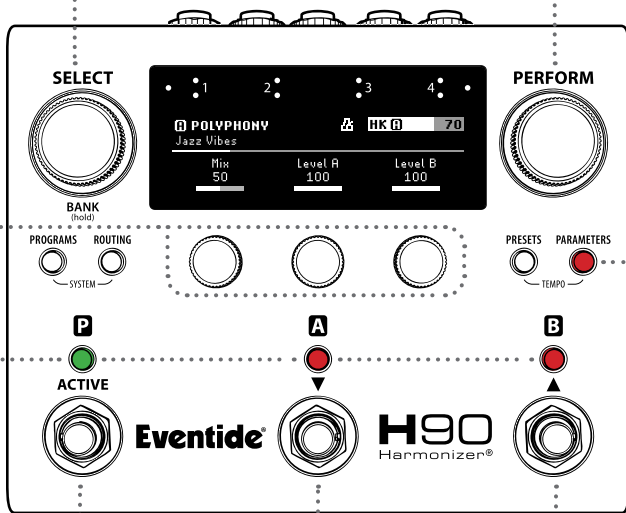

Algorithm and Preset name HotKnob **A** value



Preset name



Tempo Sync



Press PRESETS and PARAMETERS to toggle Tempo Sync On/Off



Flexible Mapping: Map any parameter to a HotKnob, expression pedal or aux switch.

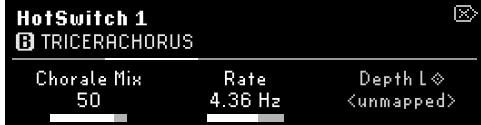

HotSwitch: Press and hold FS LED Button 1, 2 or 3 to map any parameter to three independent snapshots.

Footswitches

Press any Footswitch to exit Parameters Mode.

System

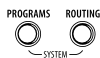

Press and hold PROGRAMS and ROUTING Buttons to enter System Menu.

Turn SELECT Knob to highlight a menu item; Press to enter.

Press PERFORM Knob to exit System Menu.



Turn SELECT Knob to highlight menu item; press again to enter.



I/O (Levels): Inputs/Outputs can be set to instrument or line level. Indicators on rear will light up for Line.

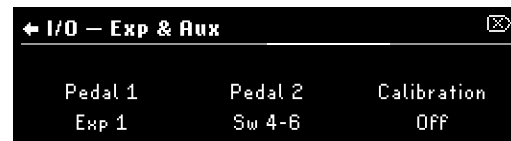

I/O (Exp & Aux): Global settings and calibration for expression pedals and footswitches.



Global: Change Insert or Dual Routing, DSP or Relay bypass, and the current Playlist.

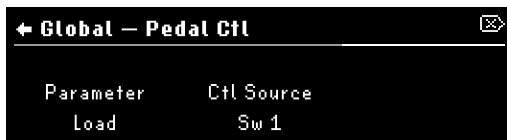

Global (Pedal Ctl): Configure control settings that are enabled for all Programs.

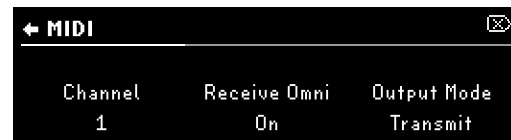

MIDI: Configure MIDI settings and CC mappings that are enabled for all Programs.

Tempo



Press and hold PRESETS and PARAMETERS Buttons to enter Tempo Menu.

Tuner

Press and hold middle and right footswitches to open Tuner.



Set the Tap Tempo BPM, and configure the Tempo source to Global, Program, or MIDI Clock.



Press PRESETS and PARAMETERS Buttons to enable **Tempo Sync** for Programs or Presets.

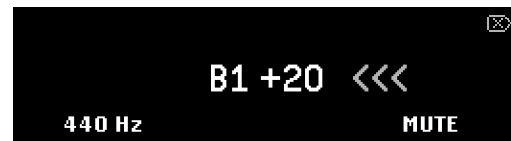

Set tuning frequency, and Mute/Thru. The Tuner is accessible in every Mode except for Perform Mode.

Quick Tips

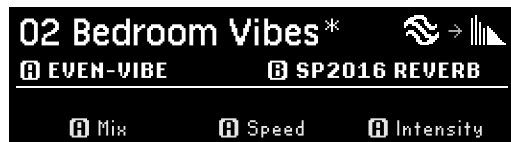

An asterisk denotes that the current Program has been modified and is unsaved.



 Diamond icon indicates that a parameter is mapped to a HotKnob or Exp/Ctl.

HotSwitch: Each of the three HotSwitches change any number of parameters with a single Footswitch.



Parameters Mode: Hold a FS LED Button to assign parameters to HotSwitch 1, 2, or 3. Press a QK to map.



Perform Mode: Assign a HotSwitch to **P**, **A** or **B** Footswitches. Only one HS can be on at a time.

Flexible Mapping: Map any parameter to an external controller, or gang parameters under one HotKnob.

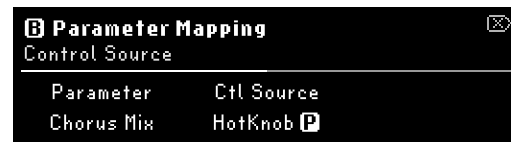

Parameters Mode: Press and hold a Quick Knob to enter parameter mapping, and select control source.

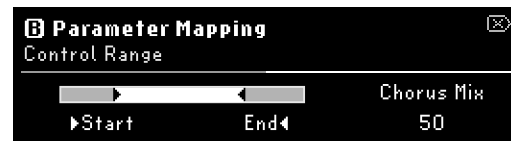

Parameters Mode: Turn QK1 and 2 to adjust the start and end points for the exp pedal control range.

H90 Control

H90 Control provides remote control access and Program list management for the H90. Manage Program and Preset settings, perform system updates, and import/export User Lists with an easy-to-use interface.

Connection Instructions

1. Download H90 Control for Mac or Windows at eventideaudio.com.
2. Power on the H90 with the provided power supply and connect it to your computer with the provided USB-C cable.
3. Open H90 Control, and click "Connect."

Reset H90 Settings

Factory Reset: Press and hold all three Quick Knobs while powering on the H90, and continue holding until the on-screen message appears.

NOTE: A factory reset deletes all user data (Lists, Programs, Presets, System and Tempo settings)

Reset System Settings: Press and hold Quick Knob 1 while powering on the H90, and continue holding until the on-screen message appears.

Eventide[®]

H90
Harmonizer[®]

VISIT US ON THE WEB



[eventideaudio.com](https://www.eventideaudio.com)

© 2022 Eventide Inc., One Alsan Way, Little Ferry, NJ 07643 USA